

A B C D E F G H J K L M N P Q R S T U

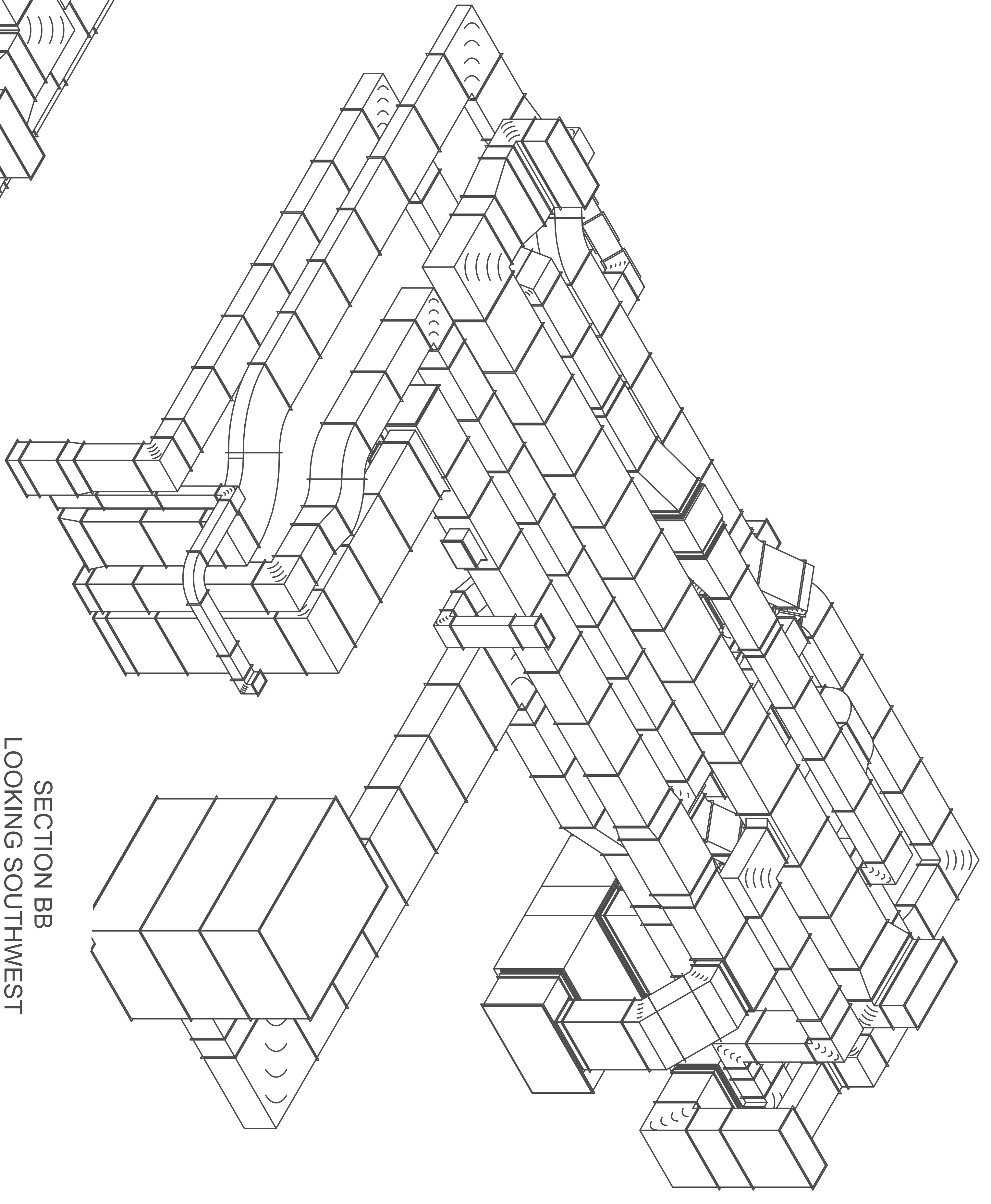

SECTION BB
LOOKING SOUTHWEST

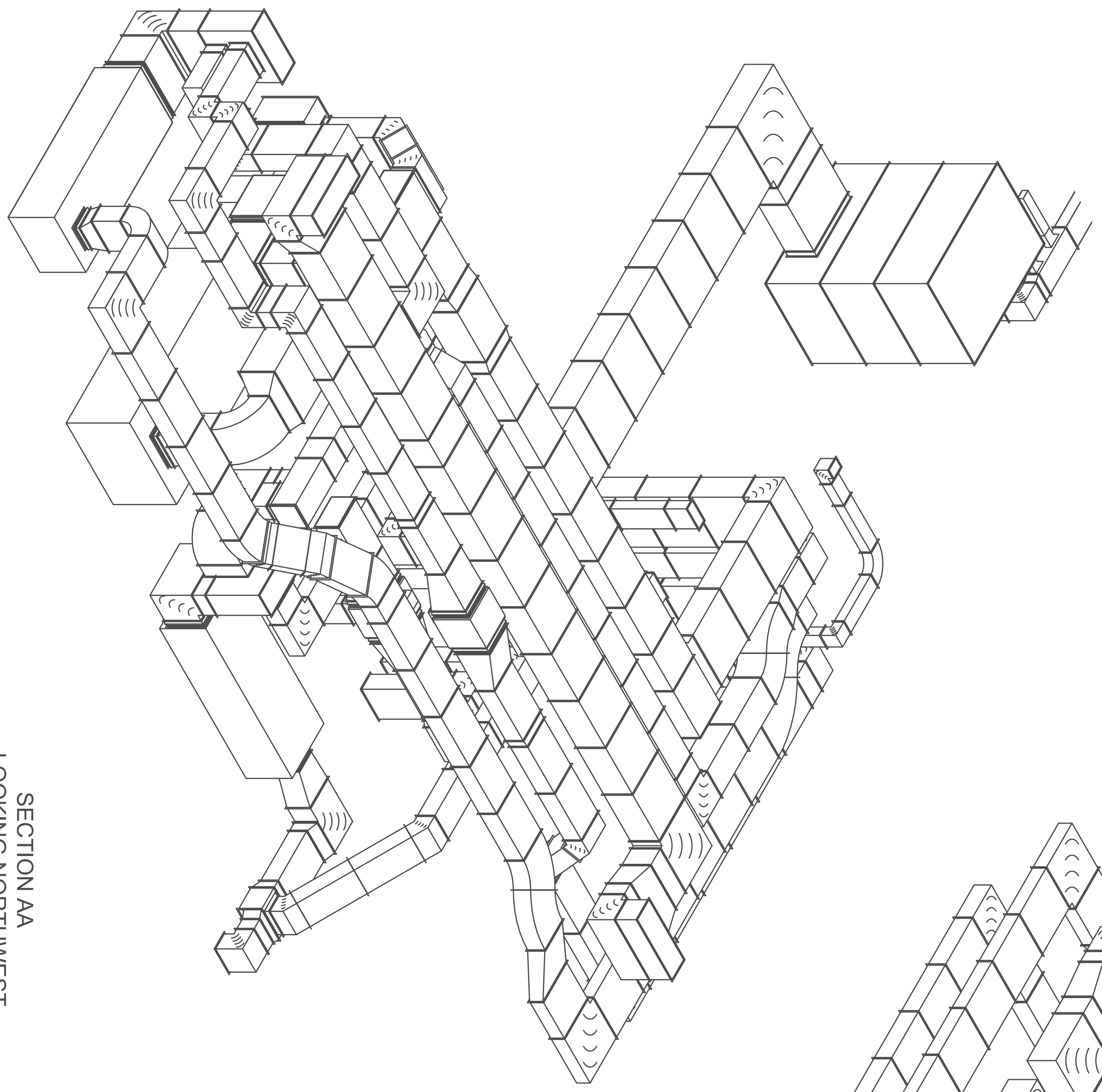

SECTION AA
LOOKING NORTHWEST

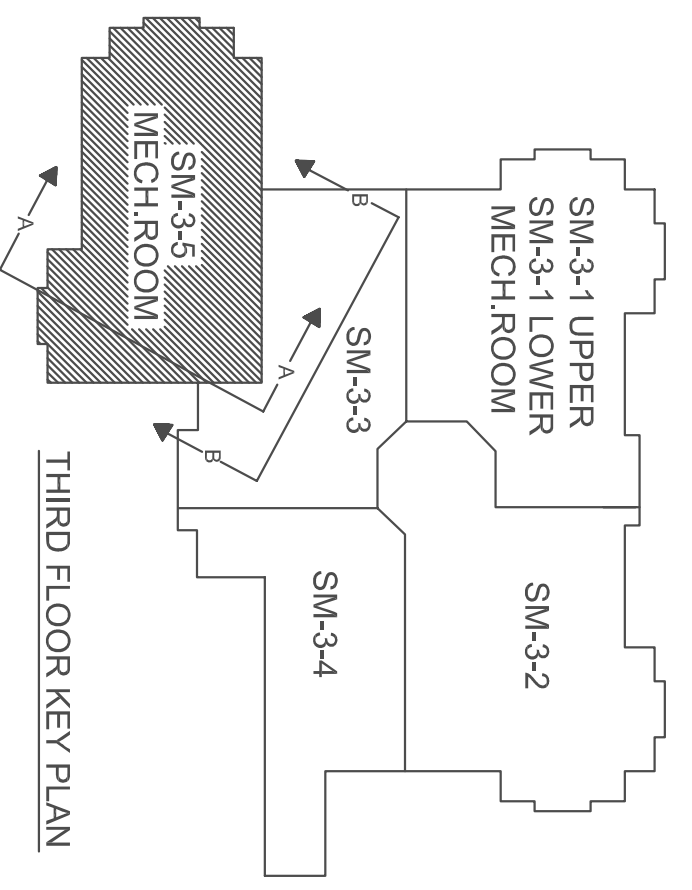

THIRD FLOOR KEY PLAN

TRADE	COMPANY	DATE	AUTHORIZED SIGNATURE
ELECTRICAL			
MECHANICAL			
PLUMBING			
SHEETMETAL			
SPRINKLER			
GEN. CONT.			
ENGINEER			
ARCHITECT			

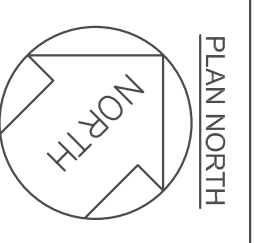

THOMAS HUNTER LOWE
HOUSE OF DELEGATES OFFICE BUILDING
ANNAPOLIS, MARYLAND

Commercial CAD
630 Eastern Ave.
Baltimore, MD 21221
E-mail: commercialcad@jumo.com
Web: www.commercialcad.com
Ph. 410.918.1424 Fax: 410.918.1434

ALLSTATE SHEET METAL
10829 PHILADELPHIA RD.
WHITE MARSH, MD 21162
PH.(410) 335-5555 FAX.(410) 335-9330

REVISIONS:

NO.	DESCRIPTION	DATE

DATE: 2/18/05
SCALE: 1/4" = 1'-0"
ARCHITECTS: COCHRAN, STEPHENSON & DOKKENROET, INC.
MECH. ENGINEER: JAMES PERRY AND ASSOCIATES
BY: C. SLETTERS
TYPE OF DRAWING: ISOMETRIC

RECORD OF TRADE COORDINATION

TRADE	COMPANY	DATE	AUTHORIZED SIGNATURE
ELECTRICAL			
MECHANICAL			
PLUMBING			
SHEETMETAL			
SPRINKLER			
GEN. CONT.			
ENGINEER			
ARCHITECT			

3-5

14 13 12 11 10 9 8 7 6 5 4 3 2 1